

PAM-CF

Manual hand staking-tool with force control

Datasheet, 01.06.2023, V2.0

 Engineered and made in Switzerland

Device for manual hands driving with force control on each spindle.
Ergonomic and intuitive, this staking-tool also allows you to record and archive the driving forces.

Machine functions

- 5 spindles
- Maximum force 150 N
- Backlight display LCD 8 x 2
- Force minimum and maximum customizable by spindle
- Stroke of spindle stop : 15 mm
- Stop lockable manually, without tool
- Battery life > 8h
- Battery charge 2h30 via USB
- Tricolor LED for force indication
- Standard tips M3 - Ø 4
- Backup and reading of the programs on SD Card



Technical specifications

Weight : 2,2 kg
Dimensions (Ø/h) : 140 x 175 mm

Available options

Rocking foot

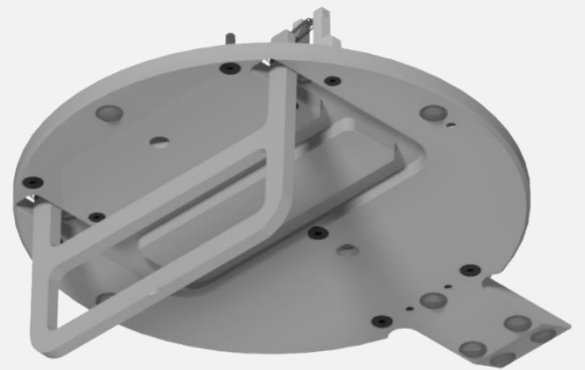

PC interface

- Program management
- Visualization of the snapping curves
- Data extraction

Tooling PAM-CF

Tooling needed

- Movement-holder realized according to specificity
- Tools for "Hour hand", "Minute hand", "Second hand" or "Eccentrically hand"

		
Stainless steel tip	Delrin tip	Peek tip
Available diameter (Ø hole)		
Ø 0,30 Ø 0,95 Ø 1,10 Ø 1,35 Ø 1,50 Ø 1,70 Ø 2,10 Plat	Ø 0,30 Ø 0,60 Ø 0,95 Ø 1,10 Ø 1,20 Ø 1,35 Ø 1,50 Ø 1,60 Ø 1,70 Ø 2,10 Ø 3,00 Plat	Ø 0,30 Ø 0,40 Ø 0,50 Ø 0,55 Ø 0,75 Ø 0,85 Ø 0,95 Ø 1,05 Ø 1,10 Ø 1,15 Ø 1,25 Ø 1,35 Ø 1,50 Ø 1,55 Ø 1,65 Ø 1,70 Ø 1,80 Ø 1,95 Ø 2,10 Plat

Tooling for off-center hands

- Plate for off-center of the movement-holder (realized according to specificity)
- Adapter plate Ø 3 pin

